

Zigzag Foot with Guide

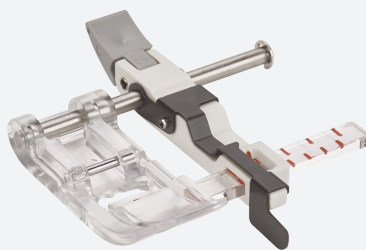

1

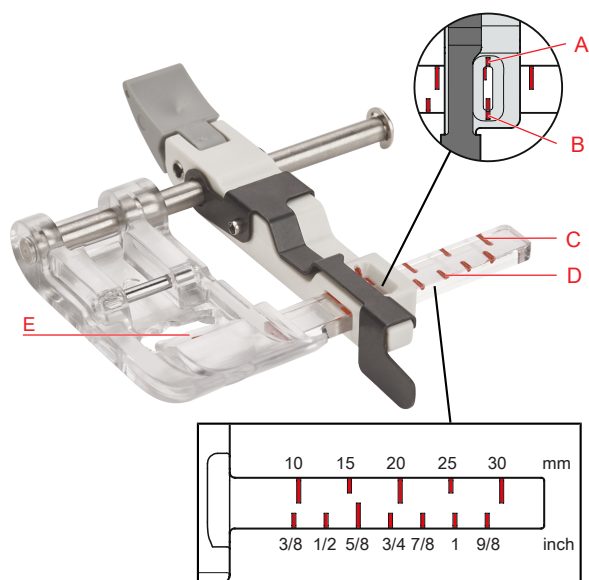

2

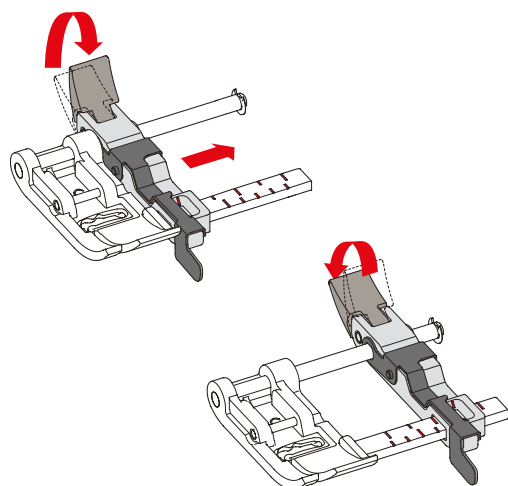

Information

Purpose

- To sew seams at an exact distance of up to 30 mm (9/8") from a fabric edge or a seam that has already been sewn.
- Ideal for quilting parallel lines, for parallel decorative seams or topstitching.

For your safety

Before using this accessory, please read this instruction manual as well as the instruction manual of your machine carefully.

Markings

- A Read mark mm
- B Read mark inch
- C Distance to the needle in mm
- D Distance to the needle in inch
- E Center needle position

Application

How to adjust the spacing between the seams

- > Push the lever upwards and slide the guide into the desired position. (Fig. 2)
- > To fix the position, lower the lever. (Fig. 2)

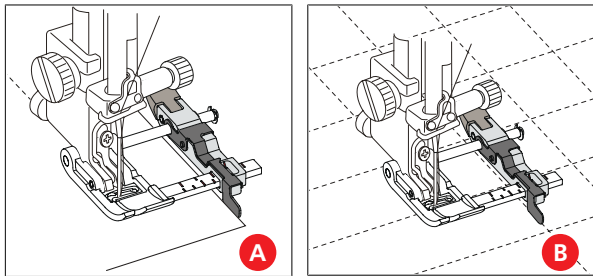

Sewing edges

- > Attach the presser foot.
- > Set the desired stitch.
- > Set the needle position to «Center».
- > Place the fabric under the presser foot and align the fabric edge (A) or the already sewn seam (B) with the guide. (Fig. 3)
- > Lower the presser foot and sew, guiding the fabric along the guide.