

STRAIGHT  
b08  
STITCH

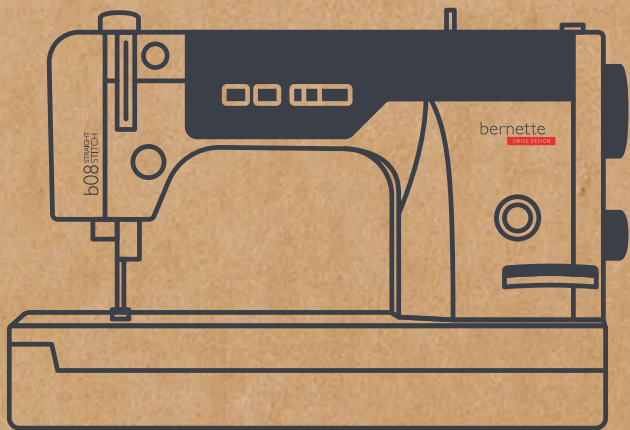

Presser Foot Set  
Quilt Making Set

bernette

SWISS DESIGN

Adjustable Free-motion Quilting Foot Set



Edgestitch Foot



Free-motion Quilting Sole Set for Quilt Frames



Adjustable Guide



Patchwork Foot with Guide



## Adjustable Free-motion Quilting Foot Set

### Adjustable Free-Motion Quilting Foot Set

The set contains two feet, one with a closed sole and one with an open-toe sole, and a darning plate to accommodate a variety of free-motion quilting and stitching applications. Due to the adjustment dial the height of the foot can be adjusted to match the thickness of the project.

**Closed-Sole Foot:** for easier gliding over the project surface

**Open-Toe Foot:** provides better view to the needle area for precise free-motion work

**Darning Plate:** bypasses the feed dog and guarantees a smooth movement of the project without snagging



- Attach the Darning Plate (fig 1)
- Raise the needle
- Attach the Free-Motion Quilting Foot
- Adjust the height of the foot by turning the nut (A) until bottom of foot just touches the top of quilt fabric (fig 2)
- To change the Foot: Raise the needle bar and loose screw (B), exchange the sole and re-tighten the screw when the other sole is mounted (fig 3)

Note: Sew at medium speed and move the quilt 3mm (1/8 inch) or less per stitch

fig 1

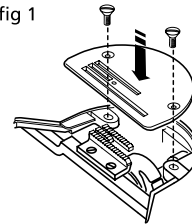

fig 2

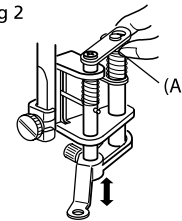
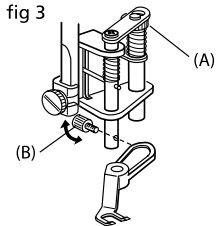

fig 3



## Free-motion Quilting Sole Set for Quilt Frames

### Free-Motion Quilting Sole Set for Quilt Frames

These additional Free-Motion soles are compatible with Adjustable Free-motion Quilting Foot.

**¼ inch Ruler Foot Sole:** This sole allows you to sew along ¼ inch high Plexi-glas rulers to create decorative quilt designs such as lines, feathers, circles, etc. This sole has an outer diameter of 1/2 inch so the net distance from the needle to the edge of the sole is 1/4 inch.

**Open Toe Frame Quilting Foot Sole:** This sole provides a better view on the needle while stitching on a quilting frame.

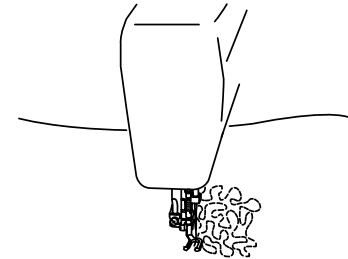
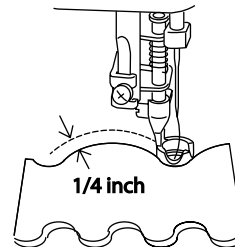

Please refer to the instruction of Adjustable Free-motion Quilting Foot Set to see how to attach and change the foot and adjust the height of the foot.

Note: Sew at a medium speed. Move the machine 3mm (1/8inch) or less per stitch.

Follow the instruction of your quilting frame or ruler/template.

## Patchwork Foot with Guide

### Patchwork Foot with Guide

This foot is ideal for quilt piecing with exact seam allowances of 1/4 inch. The fabric edges can either be guided along the foot edge or the guide, facilitating piecing with precision.



- Attach the presser foot
- Guide the fabric along the black guide on the right side of the foot or so that the raw edge of the fabric lines up exactly with the left outside edge of the foot (fig 1)
- The seam allowance will be exactly 1/4"
- Sew the fabric pieces together
- Foot marking:  
The notches on the right and left edges of the foot are 1/4" apart. The notches in the middle of the foot are in line with the point of needle penetration. The markings are helpful when the patchwork seam should start or end 1/4" in from the fabric edge.

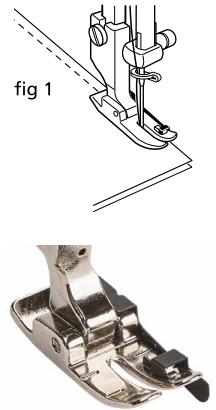

### Recommended Standard Settings

Thread Tension	4 - 5
Stitch Length	0.5 - 4.0
Foot Pressure	3 - 5

### Edgestitch Foot

This presser foot with a center guide facilitates topstitching along edges, hems and pleats. It's also helpful for sewing on lace or tapes, and for reinforcing edges. The guide helps you achieve flawless seams and hems that run parallel to the edge.



- Attach presser foot
- Place the fabric edge to be stitched just to left of and leaning against the guide
- The foot is calibrated to align the edge just a bit off the line of the needle, for precise edgestitching

Tip: usually the stitch needs to be longer for edgestitching than for sewing layers together in order to produce a neat finish.

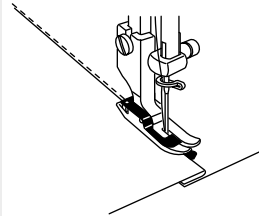

### Recommended Standard Settings

Thread Tension	4 - 5
Stitch Length	0.5 - 4.0
Foot Pressure	3 - 5

### Adjustable Guide

The Adjustable Seam Guide attaches around the presser foot shaft and works with several presser feet. There are two adjustment screws allowing you to slide the guide along the ruler rail, up to 1 1/2" to the right of the needle, to guide sewing along an edge or a previous row of a stitching.



### Adjustable Guide

- Attach presser foot. Turn off the power switch. Lower the presser foot (C). Loosen the setscrew (A) and insert the forked part of the adjustable seam guide (B) between the setscrew and the presser foot (C). Tighten the setscrew (A) firmly.
- Loosen the thumb screw (D) and align the guide (E) with the previous seam or the marking on the needle plate. Tighten the thumb screw (D) firmly.
- Loosen the thumb screw (F) and set the guide (E) in a suitable position by moving it forward or back. Set it:
  - Shorter, when guiding the seam.
  - Longer, when guiding the cloth.
- Turn on the power switch. Sew guiding the fabric with the guide (E).

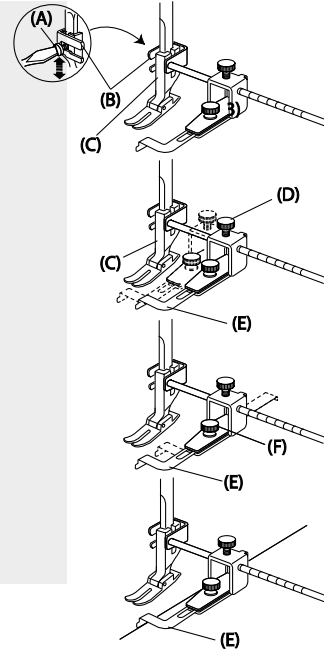



[www.bernette.com/t-rex](http://www.bernette.com/t-rex)



[www.bernette.com/accessories](http://www.bernette.com/accessories)